



**COMMONWEALTH OF KENTUCKY
TRANSPORTATION CABINET**
Frankfort, Kentucky 40622
www.transportation.ky.gov/

Matthew G. Bevin
Governor

Greg Thomas
Secretary

April 18, 2016

CALL NO. 100
CONTRACT ID NO. 161227
ADDENDUM # 1

Subject: Rockcastle County, IMD 0752 (094)
Letting April 29, 2016

(1)Added - Note - Pages 1-2 of 2

Proposal revisions are available at <http://transportation.ky.gov/Construction-Procurement/>.

If you have any questions, please contact us at 502-564-3500.

Sincerely,

A handwritten signature in cursive script that reads "Rachel Mills".

Rachel Mills, P.E.
Director
Division of Construction Procurement

RM:ks
Enclosures



An Equal Opportunity Employer M/F/D

COUNTY OF	ITEM NO.	SHEET NO.
ROCKCASTLE	8-6.60	

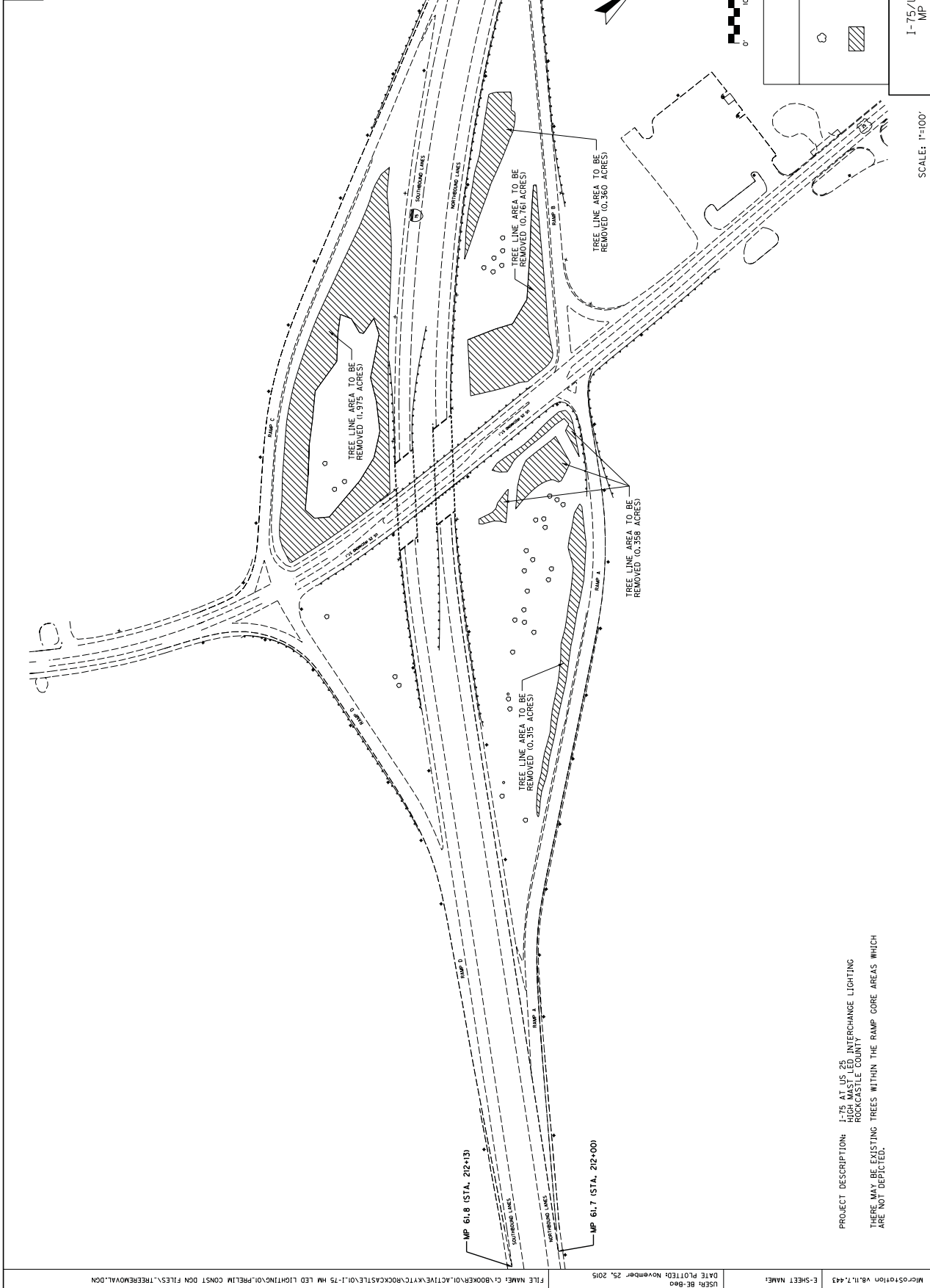

TREE REMOVAL
I-75/US 25 INTERCHANGE
MP 61.7 TO MP 62.3

SCALE: 1"=100'

LEGEND

- EXISTING TREE TO REMAIN
- EXISTING TREE LINE AREA TO BE REMOVED



MP 62.2 (STA. 99+70)
MP 62.3 (STA. 99+00)

TREE LINE AREA TO BE REMOVED (1.975 ACRES)

TREE LINE AREA TO BE REMOVED (0.761 ACRES)

TREE LINE AREA TO BE REMOVED (0.360 ACRES)

TREE LINE AREA TO BE REMOVED (0.358 ACRES)

TREE LINE AREA TO BE REMOVED (0.315 ACRES)

MP 61.8 (STA. 212+13)

MP 61.7 (STA. 212+00)

HM1 and HM2 are located near the end taper for Ramp D. This rock wall is proposed to be graded to accommodate the future road widening. Tree removal is required to install both poles.

HM 1 (General location)

HM2 (General location)



HM9 is located near the end taper for Ramp B. The rock wall is proposed to be graded to accommodate the road widening. Tree removal is required to install the pole.

HM 9 (General location)

